

PROJECT NO.	SHEET NO.	TOTAL NO.
2023CPT.11.07.10141		

SUMMARY OF QUANTITIES

														0106000000-E	1220000000-E	1245000000-E	1260000000-E	1330000000-E	1519000000-E	1575000000-E	1704000000-E
PROJECT NO	COUNTY	MAP NO	ROUTE	DESCRIPTION	Begin Milepost	End Milepost	TYP NO	LANES	LANE TYPE	FINAL SURFACE TESTING REQUIRED	WARM MIX ASPHALT REQUIRED	LENGTH	WIDTH	BORROW	INCIDENTAL STONE BASE	SHOULDER RECONSTRUCTI ON	AGGREGATE SHOULDER BORROW	INCIDENTAL MILLING	SURFACE COURSE, S9.CB	ASPHALT BINDER FOR PLANT MIX	PATCHING EXISTING PAVEMENT
														MI	FT	CY	TONS	SMI	TON	SY	TONS
2023CPT.11.07.10141	Caldwell	1	NC 18	FROM SR 1812 TO WILKES COUNTY LINE	16.73	21.38		2	2WU	NO	NO	4.65	30	140	93	9.30	1,163	1,170	7,938	572	2,001
TOTAL FOR MAP NO. 1												4.65		140	93	9.30	1,163	1,170	7,938	572	2,001
TOTAL FOR PROJ NO. 2023CPT.11.07.10141												4.65		140	93	9.30	1,163	1,170	7,938	572	2,001
GRAND TOTAL												4.65		140	93	9.30	1,163	1,170	7,938	572	2,001

PROJECT NO.		SHEET NO.	TOTAL NO.
2023CPT.11.07.10141			

THERMOPLASTIC AND PAINT QUANTITIES

										4413000000-E	4457000000-N	4810000000-E		4825000000-E	4835000000-E	4845000000-N	4840000000-N	4895000000-N
PROJECT NO	COUNTY	MAP NO	ROUTE	DESCRIPTION	TYP NO	LANES	LANE TYPE	LENGTH	WIDTH	WORK ZONE ADVANCE/GENERAL WARNING SIGNING	TEMPORARY TRAFFIC CONTROL	4" WHITE PAINT	4" YELLOW PAINT	12" YELLOW PAINT	24" WHITE PAINT	LEFT TURN ARROW	PAINT MSG SCHOOL	GENERIC MARKING ITEM NON-CAST IRON SNOW PLOWABLE MARKER
								MI	FT	SF	LS	LF	LF	LF	LF	EA	EA	EA
2023CPT.11.07.10141	Caldwell	1	NC 18	FROM SR 1812 TO WILKES COUNTY LINE		2	2WU	4.65	30	605	1.00	100,068	100,068	800	500	8	24	307
TOTAL FOR MAP NO. 1								4.65		605	1	100,068.00	100,068	800	500	8	24	307
TOTAL FOR PROJ NO. 2023CPT.11.07.10141								4.65		605	1	100,068.00	100,068	800	500	8	24	307
												200,136.00						

8/17/99
24-JAN-2023 13:39
M:\2023\Road\2023\Spring Resurfacing\typicals.dgn
24-JAN-2023 13:39
M:\2023\Road\2023\Spring Resurfacing\typicals.dgn
24-JAN-2023 13:39
M:\2023\Road\2023\Spring Resurfacing\typicals.dgn

- * "PATCHING EXISTING PAVEMENT" HAS BEEN INCLUDED AS A PAY ITEM ON MAPS. PATCHING MAY OR MAY NOT BE NEEDED DEPENDING ON CONDITION OF MAP SURFACE AT TIME THAT PAVING SEASON BEGINS. AREAS TO BE DELINIATED BY THE ENGINEER.
- * INCIDENTAL MILLING AT LOCATIONS AS DIRECTED BY THE ENGINEER

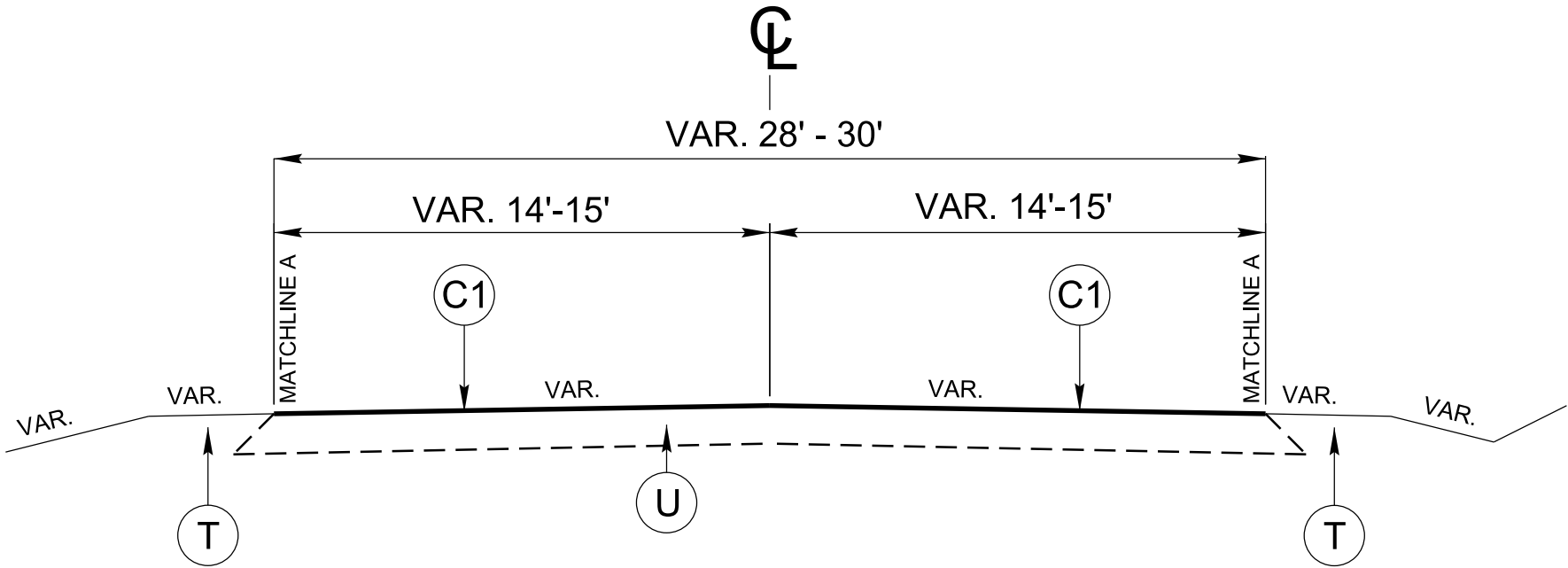

TYPICAL SECTION NO. 1

**MAP 1 - NC 18 FROM SR 1812 TO WILKES CO. LINE

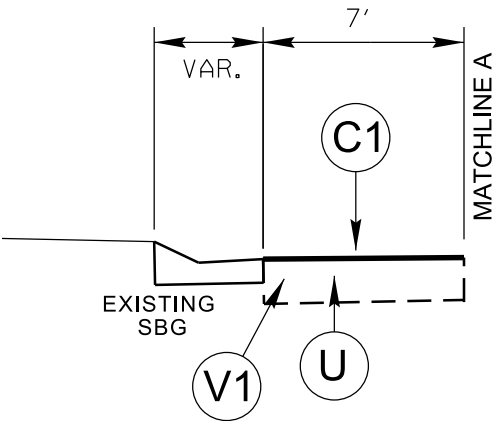

INSET NO. 1A **

NOTE: INSET NO. 1A IS MIRRORED THE SAME ON LT AND RT SIDES
MAP 1 - VARIOUS SPOT LOCATIONS (WHEN EXIST. SBG IS PRESENT)

*** (Note: Asphalt Ditches may be present on any map. In such cases, the contractor is to clean ditches and refer to the corresponding detail for construction guidance as directedby the engineer.)

PROJECT REFERENCE NO.	SHEET NO.
DK00353	01

PAVEMENT SCHEDULE	
C1	PROP. APPROX. 1½" ASPHALT CONCRETE SURFACE COURSE, TYPE S9.5C, AN AVERAGE RATE OF 168 LBS. PER SQ. YD.
T	SHOULDER RECONSTRUCTION
U	EXISTING PAVEMENT
V1	INCIDENTAL MILLING (See Tie in Detail)

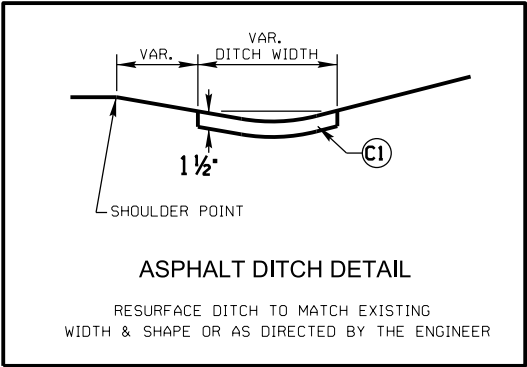
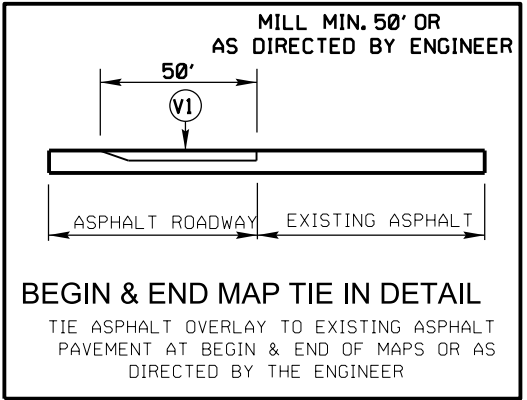

NOTE: TYPICALS ARE NOT TO SCALE

Caldwell County Primary Roads 2023 Asphalt Resurfacing (Spring Let)			
REVISIONS		INIT.	DATE
N.C. DEPARTMENT of TRANSPORTATION DIVISION of HIGHWAYS DIVISION ELEVEN		SCALE: N/A	DATE: 1/12/2023
		PREPARED BY:	D.O.N
		REVIEWED BY:	
		REVIEWED BY:	

CALDWELL COUNTY

TYPE OF WORK: ASPHALT RESURFACING
MAP # 1

2023

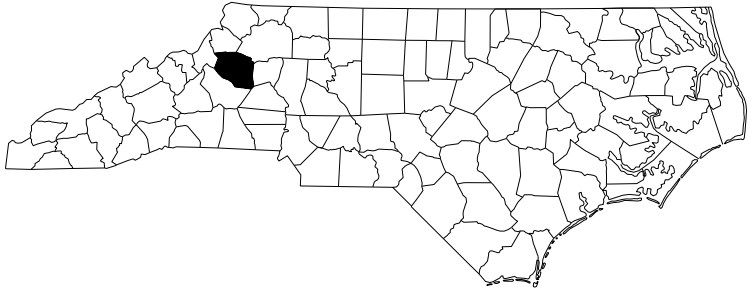

MAP #1

* NC 18 - (4.65 mi.)
(FROM SR 1812 TO WILKES CO. LINE)

SIGNING FOR RESURFACING PROJECTS

LEGEND

STATIONARY SIGN

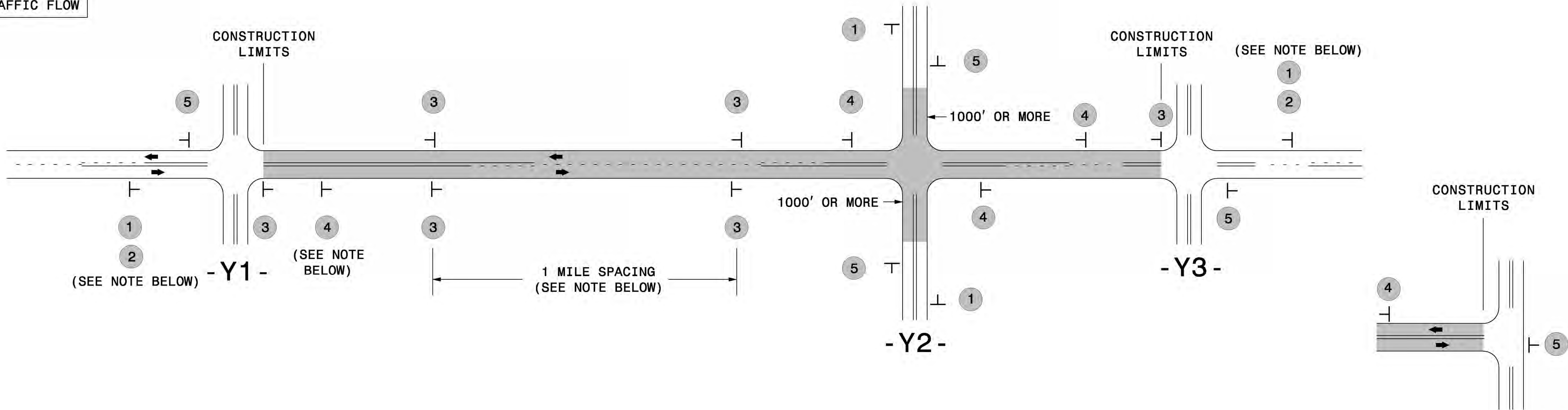

DIRECTION OF TRAFFIC FLOW



TEE INTERSECTION

MAINLINE (-L-) SIGNING

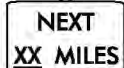
-Y- LINE SIGNING

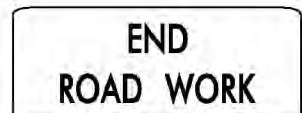
SIGNING NOTES AND PLACEMENT PER DIRECTION	<div>1</div> <div><div>W20-1 48" X 48"</div></div> <div>2</div> <div><div>W7-3aP 24" X 18"</div></div> <div>PLACE 1000' PRIOR TO BEGINNING OF CONSTRUCTION LIMITS. ONLY USED ON -Y- LINES IF RESURFACING LIMITS EXTEND 1000' ALONG -Y- LINE.</div> <div>#2 SIGN ONLY USED WHEN CONSTRUCTION LIMITS ARE 2 OR MORE MILES IN LENGTH. ROUND UP TO NEXT WHOLE NUMBER.(NO FRACTIONAL OR DECIMAL NUMBERS)</div>	NO REQUIRED STATIONARY SIGNING FOR THE FOLLOWING -Y- LINE CONDITIONS: 1) LESS THAN 1000' OF RESURFACING ALONG -Y- LINE 2) SUBDIVISION ROADS 3) DEAD END ROADS WHEN PAVING/CONSTRUCTION ACTIVITIES PROCEED ACROSS AN UNSIGNED -Y- LINE, PORTABLE ADVANCE WARNING SIGNS SHALL BE USED ALONG THE -Y- LINE AS SHOWN BELOW. REMOVE UPON COMPLETION OF WORK.
	<div>3</div> <div><div>SP 13107 48" X 48"</div></div> <div>- PLACE INITIALLY AT THE CONSTRUCTION LIMITS AND SPACE 1 MILE APART THEREAFTER. - AT TEE INTERSECTIONS INSTALL INITIALLY 1/2 MILE FROM INTERSECTION AND SPACE 1 MILE APART THEREAFTER.</div>	
	<div>4</div> <div><div>SP 13106 48" X 48"</div></div> <div>- THESE ARE FOR -Y- LINES THAT ARE "THROUGH" ROADWAYS. - DEAD END AND SUBDIVISION ROADS ARE NOT "THROUGH" ROADWAYS. - INSTALL 500' +/- FROM EACH -Y- LINE APPROACH AS SHOWN ABOVE. - FOR MULTIPLE -Y- LINES THAT ARE SEPARATED BY 0.25 MILES OR LESS, TREAT AS A SINGLE UNIT AND INSTALL WITHIN 500' OF EACH APPROACH. - A MAXIMUM OF 2 SIGN SETS PER MILE. DO NOT INSTALL WHEN -Y- LINES ARE WITHIN 0.5 MILES FROM "END ROAD WORK" SIGN. - FOR TEE INTERSECTIONS, INSTALL WITHIN 500' +/- OF THE INTERSECTION ALONG -L- LINE.</div>	
	<div>5</div> <div><div>G20-2 A 48" X 24"</div></div> <div>PLACE 500' FOLLOWING THE END OF CONSTRUCTION LIMITS OR AS SHOWN WHEN WORK ENDS AT A 3-WAY TEE INTERSECTION.</div>	
	THE ABOVE SIGNS ARE ALL THAT ARE REQUIRED FOR A CONTRACTOR TO BEGIN A RESURFACING CONTRACT. ANY ADDITIONAL SIGNS REQUESTED BY NCDOT DIVISIONS SHALL BE INSTALLED WITHIN 7 BUSINESS DAYS OF THE START OF CONTRACT WORK.	
LESS 2 MILES	FOR RESURFACING MAPS WITH CONSTRUCTION LIMITS LESS THAN 2 MILES IN LENGTH, NO STATIONARY SIGNS ARE REQUIRED. USE PORTABLE "ROAD UNDER CONSTRUCTION" OR "ROAD WORK AHEAD" SIGNS IN LIEU OF STATIONARY ADVANCE WARNINGS SIGNS.	



W20-1
48" X 48"

PLACED 500' IN ADVANCE
OF FLAGGER.



W20-7 A
48" X 48"

PLACED 250' IN ADVANCE
OF FLAGGER.

DIVISION OF HIGHWAYS

STATE OF NORTH CAROLINA

DEPARTMENT OF TRANSPORTATION

WORK ZONE TRAFFIC CONTROL

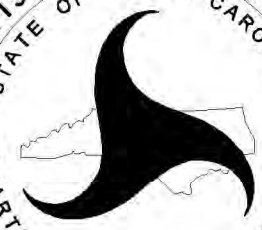

AD



ADVANCE WARNING SIGNS
FOR
RURAL AND SUBURBAN
2-LANE ROADWAY
RESURFACING